

TILE/BRICK DRILL BIT KERAMIK WITH TSM CARBIDE TIP | 151

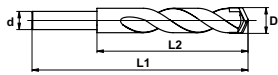

DRIVE



D Ø mm	D Ø "	L2 mm	L1 mm	d Ø mm		EAN 4016707...	12345
4,0	5/32	40	75	3,6	20	510106	151 018 040
5,0	3/16	50	85	4,6	20	510113	151 018 050
5,5	7/32	50	85	5,1	20	904875	151 018 055
6,0	15/64	60	100	5,6	20	510120	151 018 060
6,5	1/4	60	100	6,1	20	904882	151 018 065
8,0	5/16	80	120	7,1	20	510137	151 018 080
10,0	3/8	80	120	8,7	20	510144	151 018 100
12,0	15/32	90	150	10,0	10	510151	151 018 120
14,0	9/16	90	150	10,0	10	510090	151 017 140

EXECUTION

- ISO 5468
- Asymmetric spiral shape
- Milled flute for optimum removal of drilling dust
- Straight flute entry
- Tungsten-titanium TSM carbide tip
- High-temperature brazing at about 1,120°C
- Burnished surface
- Up to 12 mm Ø with ROTASTOP shank

FOR USE IN



APPLICATION

- In all rotary and percussion drilling machines
- High contact pressure
- 20 seconds cooling time
- Only for rotary use
- In materials up to scratch hardness of 9
- Drilling process and tool life can be increased by cooling with water

PACKAGING

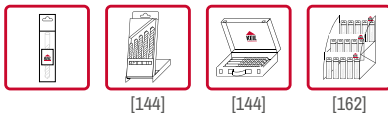

[144]

[144]

[162]

TILE/BRICK DRILL BIT

FEATURES:

- A new technology makes it possible to use this high-performance rotary drill bit for dry drilling in hardest ceramic, porcelain stoneware, tiles and hard burnt brick up to a scratch hardness of 9
- The tungsten-titanium tip is a diamond-ground special carbide tip
- The special grinding has been adapted for the drilling of particularly dense material and guarantees a long life – up to 500% longer than comparable products.
- Low-stress high-temperature brazing at 1,120°C prevents detaching of the extremely hard and sharp carbide tip even under excessive loads.
- The intended microscopic breakouts on the cutting edges provide edges which stay sharp.



DRILLING INFORMATION:

- A recommended speed of 600 to 1,200 rpm and sufficient contact pressure, which is always required for the exclusively rotary drilling of hard materials, are the prerequisites for good drilling progress and a long life of the drill tip.
- When used with rechargeable drilling machines the drill bit provides noticeably faster drilling than comparable rotary drill bits.
- We recommend to affix adhesive tape at the place of drilling.



ROTASTOP:

- The polygonal shape of the ROTASTOP section on the outside of the drill bit reduces surface contact to 3 points which leads to a reduction in the frictional resistance and thus to a considerably higher rate of work with noticeably improved performance of the drill bit.
- ROTASTOP allows easy tool changing within seconds and longer service lives for the tools.
- Optimal torsional rigidity | Low frictional losses | High drilling performance

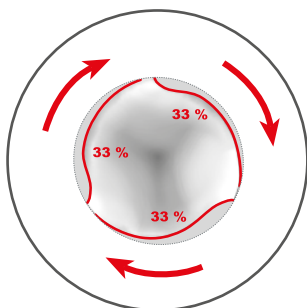

PRODUKT INFORMATION ROTASTOP:

- Strength from the contour. The new performance shank for optimum torque transmission
- An unmatched 99 % of the contour of the ROTASTOP tool bit ensure optimum transmission of the torque, as ROTASTOP practically chucks itself automatically by means of the rising contours.
- The result: No slipping in the chuck and precise results when processing material.

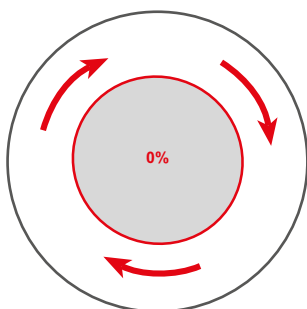

TILE DRILL BIT / KERAMIK DIAMOND - DRY DRILL | 786

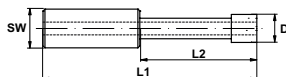

TILE DRILL BIT / KERAMIK DIAMOND | 786



DRIVE

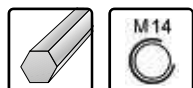

D ø mm	L1 mm	SW mm	rpm	Box	EAN 4016707...	12345
5,0	67	9,00	2.000	1	905735	786 090 050
6,0	67	9,00	2.000	1	905742	786 090 060
8,0	80	9,00	1.800	1	905759	786 090 080
10,0	80	9,00	1.600	1	905766	786 090 100
12,0	80	9,00	1.400	1	905773	786 090 120
15,0	80	9,00	1.400	1	905780	786 090 150
20,0	70	9,00	1.400	1	905797	786 090 200
25,0	70	9,00	1.400	1	905803	786 090 250
30,0	70	9,00	1.200	1	905810	786 090 300
35,0	70	9,00	1.200	1	905827	786 090 350
68,0	70	9,00	800	1	905865	786 090 680

EXECUTION

- Vacuum-soldered diamonds
- Burnished surface
- Hollow section completely filled with cooling liquid (up to Ø 15mm)

TILE DRILL BIT KERAMIK DIAMOND WITH INTERNAL SCREW THREAD M14 | 788



FOR USE IN



- In all rotary and percussion drilling machines
- Recommended cooling time 10 seconds
- For rotary use only
- In materials up to scratch hardness 9
- Dry drilling, no water necessary
- Long tool life with water supply

D ø mm	L1 mm	SW mm	rpm	Box	EAN 4016707...	12345
5,0	62	M14	10.000	1	915673	788 140 050
6,0	62	M14	10.000	1	915680	788 140 060
8,0	62	M14	10.000	1	915697	788 140 080
10,0	62	M14	10.000	1	915703	788 140 100
12,0	62	M14	10.000	1	915710	788 140 120
15,0	62	M14	10.000	1	915727	788 140 150
20,0	60	M14	10.000	1	915734	788 140 200
25,0	60	M14	10.000	1	915741	788 140 250
30,0	60	M14	10.000	1	915758	788 140 300
35,0	60	M14	10.000	1	915765	788 140 350

PACKAGING

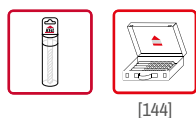

ACCESSORIES FOR TILE DRILL BIT KERAMIK DIAMOND



No	Box	EAN 4016707...	12345
1	1	580086	786 100 000
2	1	580093	786 100 002
3	1	580130	786 200 000
4	1	580123	786 200 001

TILE DRILL BIT KERAMIK DIAMOND - DRY DRILL

Dry drilling in hardest materials, hard stoneware tiles, porcelain, bricks, glass, marble, granite and slate.

ADVANTAGES:

- Fast drill progress
- Long tool life
- Clean cutting edge
- Dry drilling



For the complete installation of a bathroom a high number of bore holes in hard material is necessary. These materials become more and more demanding where the appropriate drilling tool is concerned. Nowadays not only plain tiles are used but hard stoneware like porcelain quality 5, marble, granite, hard ceramics as well as hardened tiles.

The Tile drill bit KERAMIK diamond is the ideal drilling tool to set safely and effectively a clean and precise hole. The advantage of these drill bits are the long durability and the speediness of the drilling process.

The drill bits are completed by professional accessories which guarantee that the drilling will be set on the exact place where it was planned. The two former plates are secure and foot-sure by the use of big vacuum suction stands. So they give the drill bit a secure hold for a precise drill. As additional possibility besides water supply herewith KEIL offers a complete system. The add-on water prolongs tool life, but is not necessary in principle.



Recommended rotation speed
Tile drill bit / KERAMIK diamond 786 - dry drill

D ø mm	Ø/min
5,0	2000
6,0	2000
8,0	1800
10,0	1600
12,0	1400
15,0	1400
20,0	1400
25,0	1400
30,0	1200
35,0	1200
68,0	800

PILOT DRILLING WITHOUT ANY FACILITIES

